



# GRANITE BAY TOWN CENTER

**8731-8799 AUBURN-FOLSOM RD  
GRANITE BAY, CA 95746**

**FOR LEASE**

Listed Exclusively by:

**Bill Perkins**  
bp@corecre.com  
916. 274. 4402  
CA DRE #01114501

**CORE**  
COMMERCIAL

CORE Commercial  
2264 Fair Oaks Blvd, Sacramento, CA 95825  
CA DRE #01904661

## GRANITE BAY TOWN CENTER Granite Bay, CA

- Center Anchored by Ace Hardware, Gold's Gym
- Ample Parking
- Fast Food and Full-Service Restaurants On Site
- Affluent Submarket with \$115,500 Median Income w/in 1 Mile
- Only Retail Intersection in Underserved Area

### ANCHORED CENTER

This is a part of Granite Bay Village, anchored by Ace Hardware, Gold's Gym, and USPS, on Auburn-Folsom Road, connecting the main north/south route for Granite Bay.

### AVAILABLE SPACE

- ±1,920 SF adjacent to USPS
- ±2,200 SF In-Line
- ±575 SF Streetfront Space

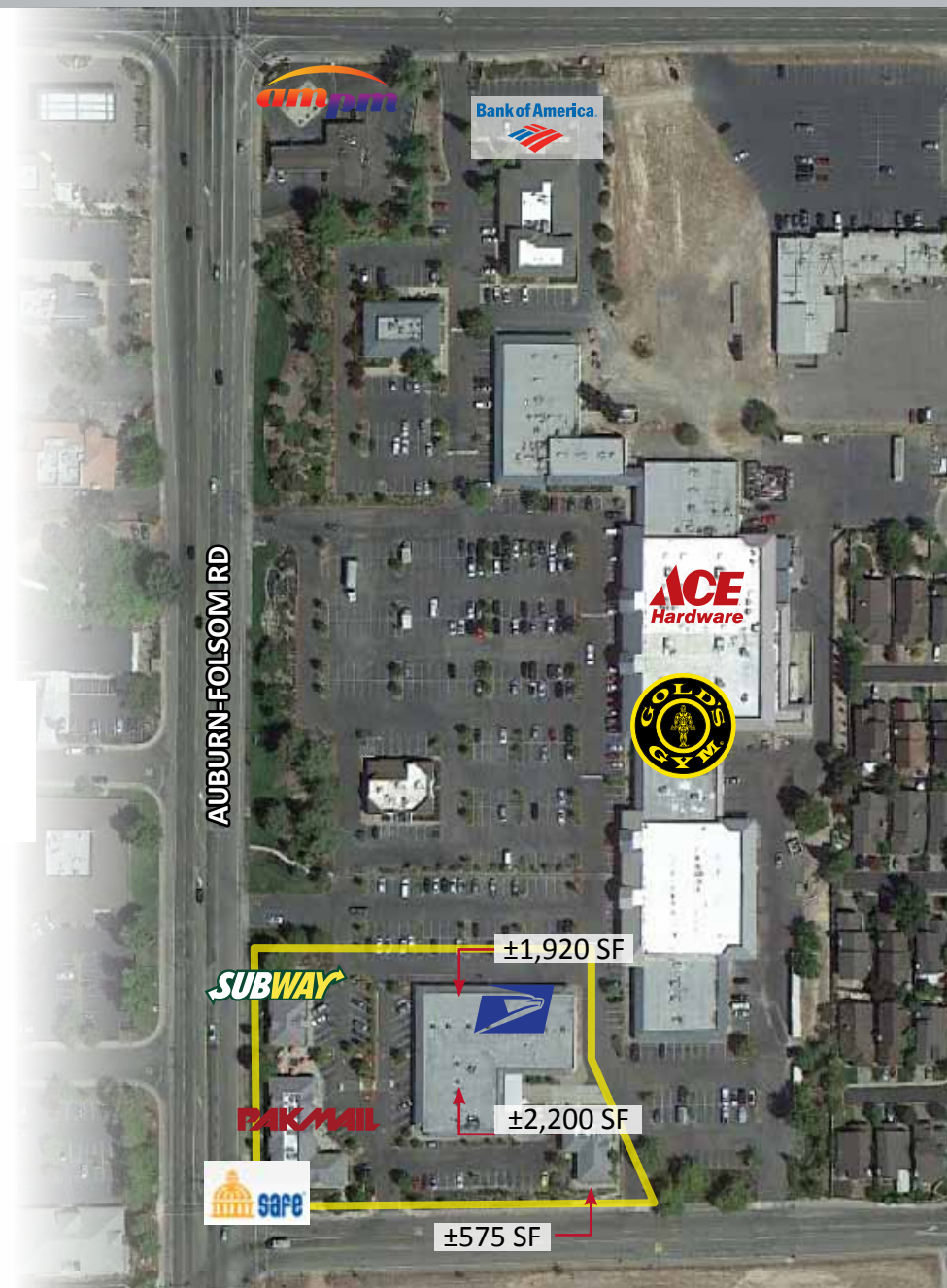

Lease Information:  
**Bill Perkins**  
bp@corecre.com  
916. 274. 4402

**CORE**  
COMMERCIAL

# GRANITE BAY TOWN CENTER Granite Bay, CA

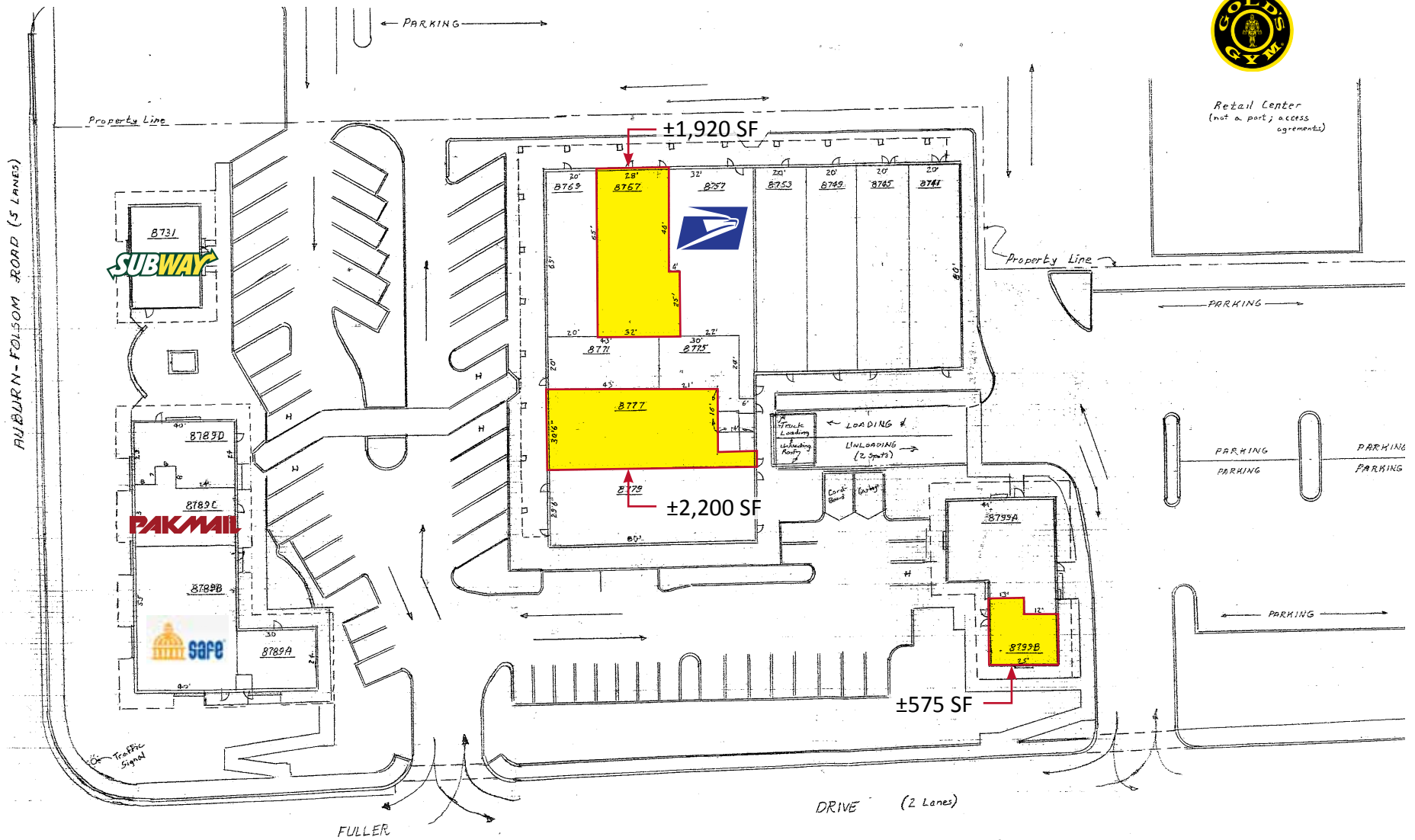

Lease Information:  
Bill Perkins  
bp@corecre.com  
916.274.4402

CORE  
COMMERCIAL

**GRANITE BAY TOWN CENTER** Granite Bay, CA



Lease Information:  
**Bill Perkins**  
bp@corecre.com  
916. 274. 4402

**CORE**  
COMMERCIAL

# GRANITE BAY TOWN CENTER Granite Bay, CA



DEMOGRAPHICS	1 mi	2 mi	5 mi
Est Population	3,880	28,220	114,870
Average H'hold Income	\$163,300	\$174,500	\$117,750
Median H'hold Income	\$115,500	\$121,500	\$93,750
Daytime Employees	942	5,690	48,780



Lease Information:  
**Bill Perkins**  
 bp@corecre.com  
 916. 274. 4402

**CORE**  
 COMMERCIAL

# GRANITE BAY TOWN CENTER Granite Bay, CA

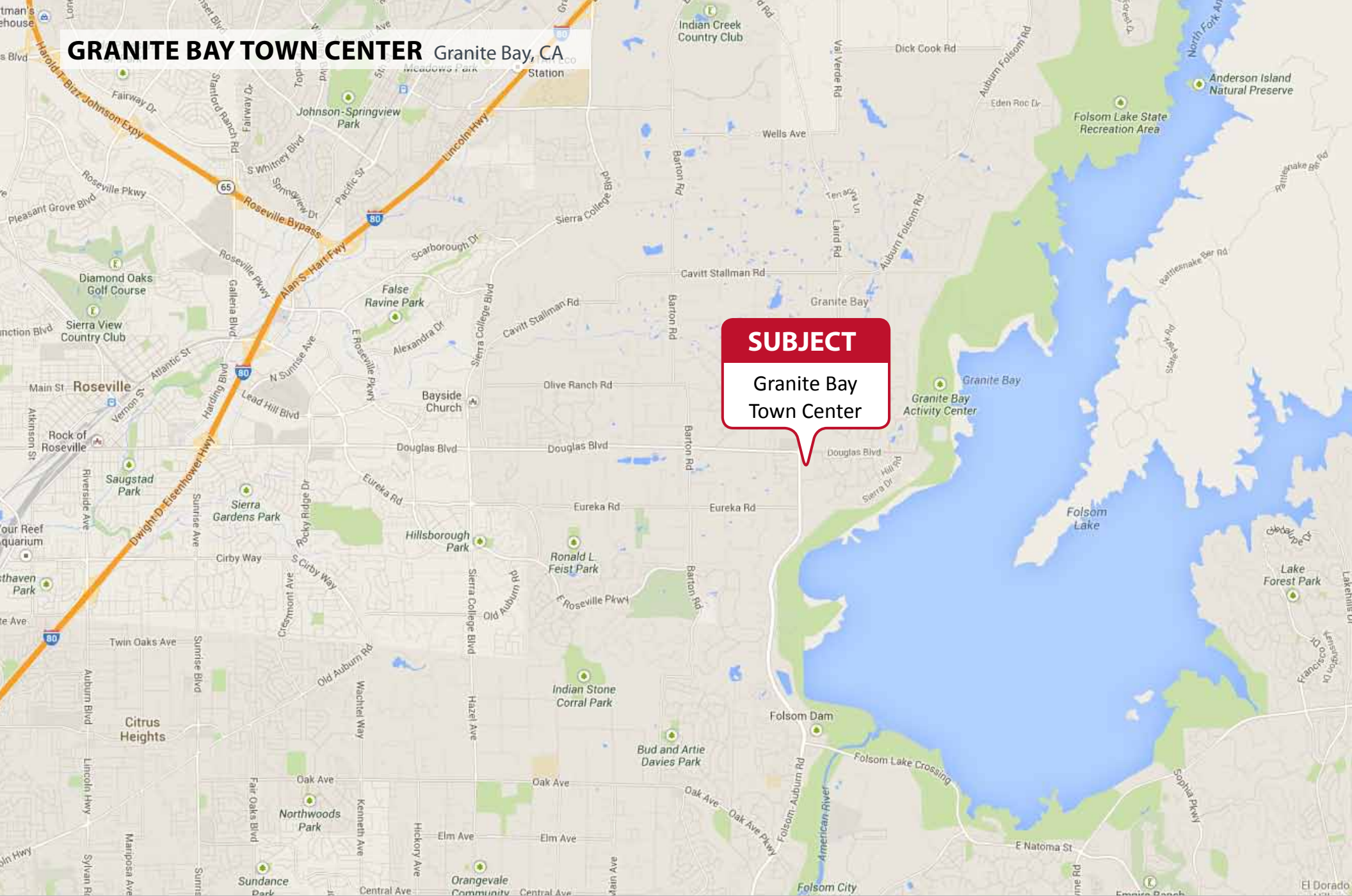

**SUBJECT**

Granite Bay  
Town Center

COPYRIGHT © 2013. ALL RIGHTS RESERVED. CORE Commercial ("Agent"), CA DRE Lic. 01904661, has presented this brief, selected information pertaining to the Property and shall not be considered all-inclusive or unchanged since the date of preparation. No warranty as to the accuracy or completeness is expressed or implied. The information has been received from sources believed to be reliable but is not guaranteed. Prospective Tenants should independently verify each item of information and have the same reviewed by its tax advisor and/or legal counsel. The Property is being leased on an "as-is, where-is" and "with all faults" basis unless otherwise specified.

**CORE**  
COMMERCIAL